



StreamBIM

by Rendra AS



**EASY - FAST -
AND AT YOUR FINGERTIPS**

streambim.com

Info



StreamBIM is a BIM based and datacentric collaboration- platform for the AEC industry. Customers value our user-friendly interface that enables easy implementation in any project or organization.

StreamBIM makes BIM collaboration and datamining easy. Our platform runs on any device, ensuring that information flows freely between the design- office and the construction site. Plan and coordinate design in real-time for BIM coordination, punch lists, production planning, issue management and more.

On site, use our Capture and Checklist modules to manage QA, Health and Safety and production progress. With StreamBIM, all your 3D models and production drawings are just a few finger strokes away.

Are you missing vital dimensions on production drawing? With StreamBIM's precise measuring tool you can find the measurements you want when and wherever you need them, paving the way for drawing free projects.

Our innovative streaming technology enables you to spin, inspect and query gigabytes of BIM files on your smartphone or tablet with ease. No project is too large and complex for true BIM collaboration in StreamBIM.

With our powerful "Realtime quantity takeoff" from models and easy integration with 3rd party software, we enable companies to take control of their highly valuable data.

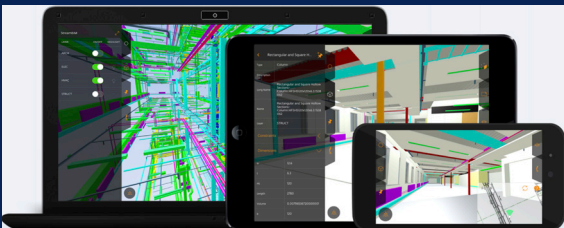

State of the art security

Security is highly important, so we have started the process of ISO 27001 certification both in Europe and in Japan.

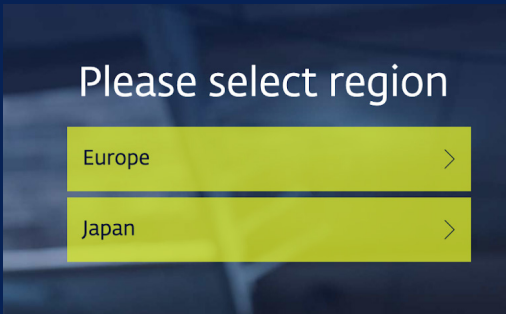

In addition, we can:

- Run on-premise.
- Support confidential projects.
- Flexible server placement, we have servers in Europe and Japan. And can set up new servers on request.
- Support IP whitelist.

This means your data is safe with us!



Capture - BIM on site



Example of on- site communication using the Capture module

Register and communicate deviations or incidents on the construction site easily with the "Capture module".

Use a phone, tablet or PC/BIM station on a construction site to document or communicate seamlessly with other interests. Take pictures with your phone or tablet and add it directly to your issue. That way, you have all incidents and communications traceably available when you need it.

Everything is available on StreamBIM for as long as you want, and it is also easy to download reports such as excel, pdf, BCF or directly to your PowerBI dashboard.

Create your own "Views" with the geometry, models and information you need, and save it to a "Capture" topic. That way you can share the View to anyone needed. This is extremely useful for creating "work-packages" and making 3D views for "Iron – Reinforcements".



Example of BIM stations on- site

Checklists

Enable smart workflows and overview for your project teams with our intuitive checklists.

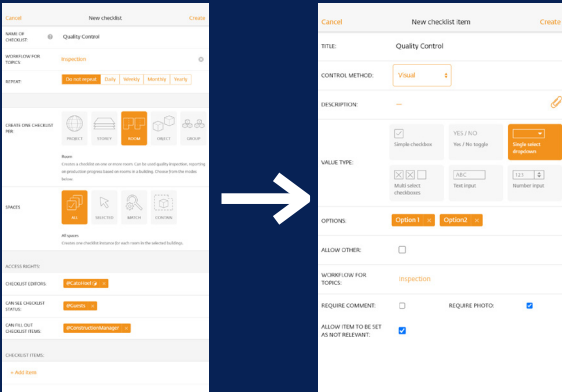

- It is easy to create checklists that fit the company's quality standard and reuse as templates for future projects.
- With a few clicks the checklists are added to spaces, systems, type objects, floors and property values in your model.
- With the coordinates in 3D (X,Y,Z) added to the checklists you get a overview on where your inspections are done or not, and if you have deviations.
- You can apply filters which give the objects with a checklist a status color, this gives you a full overview of which elements have completed the quality control.
- If an element gets deviation in your checklist, the checklist will not be given the status of approved until the deviation has been closed.
- Generate valued reports when you need them.

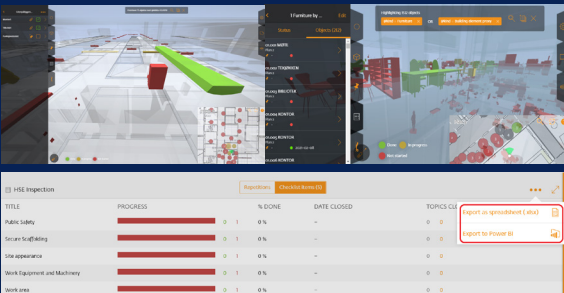

Measurements on the go

World class measurement tool that works just as well on your phone as on a computer.

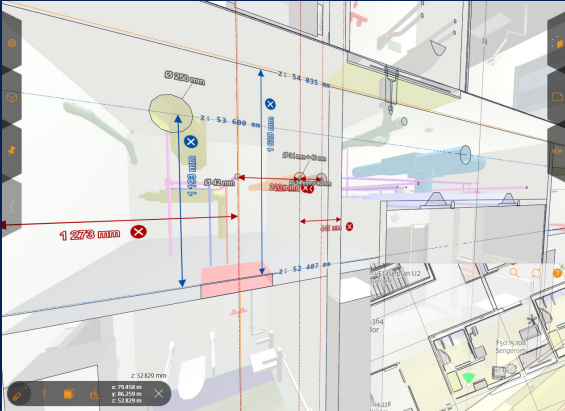

Do measurements on the go or save your view with all measurements you need for use later. You can give access to the predefined views to other parties, this enables paper and drawing- less production.

- Enable a measure plain for easy measurements.
- End to end or multipoint measure.
- Snaps to grids.
- Circular dimensions are added automatically.
- Smart pipe snap- points.
- Measure to pipes with fall.

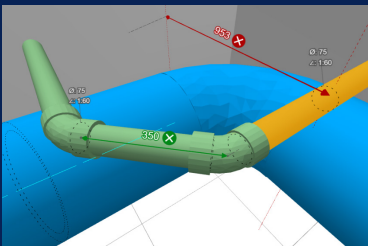

Document and file storage

Get access to your documents and drawings on any device.



Find the drawing you need with just a few clicks with our smart tags. Add your important documents to favorites for easy access when you plan to use them. The tags is added to the folder structure, so when you upload drawings they automatically get tagged correctly.

You can add any pdf or picture directly to captures or checklists. As an example, you can add mounting instructions to a capture for use in production.

It's easy to:

- Set user rights and access to any file.
- Do quick measurements on any pdf drawing.
- Get access to previous revisions.
- Restore deleted items.
- Backup your archive when your project ends.
- Sync from 3rd party document storage vendors (if needed).

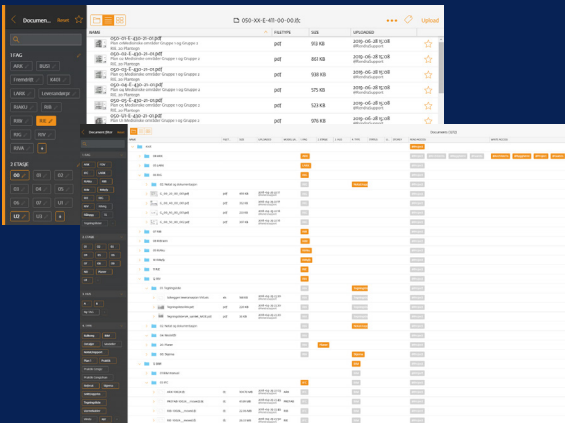

QR Codes

Generate QR codes for quick indoor positioning or product labelling.

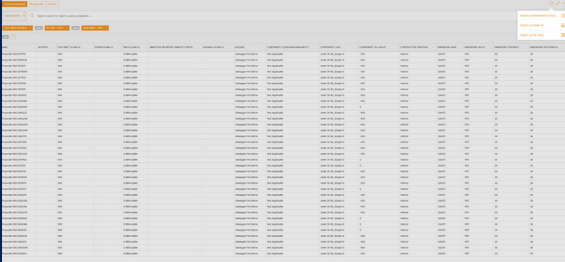

The screenshot shows a software interface with a table containing numerous columns of data, likely representing BIM object properties such as name, type, location, and material. The interface includes search bars and navigation controls at the top.

Its easy to generate QR codes in StreamBIM, and You can add any object-information to your labels. The usage is without limitations! E.g. you can use the codes for:

- Easy access to product documentation.
- Easy access to issue / Quality control.
- Indoor positioning – Takes you to the correct position in the 3D model.
- Easy mapping from the BIM object to material procurements.
- And so on...

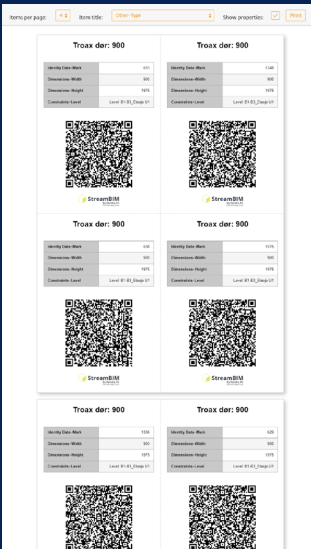

The screenshot displays the StreamBIM web interface. At the top, there are search filters for 'Items title' and 'Other Type'. Below, a grid of six labels is shown, each for a 'Troax der: 900' object. Each label includes a table of properties: 'Mounting Hole Mark', 'Dimension Width', 'Dimension Height', and 'Coordinate Level'. Below the table is a QR code and the StreamBIM logo.



Realtime quantity takeoff

It's easy to get an overview of data your models and take ownership of important BIM data with StreamBIM.

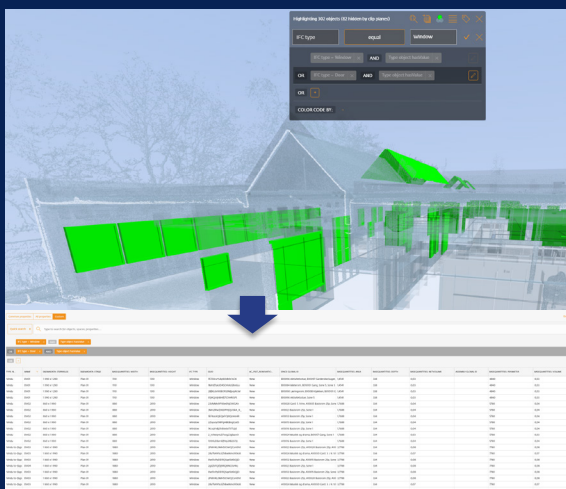

Derive real-time quantities from models with 3 clicks:

- Numbers
- Lengths (in system)
- Areas and volumes (Aggregated from properties)
- Full flexibility of what data - parameters you want to include in your report.
- Easy export to excel or PowerBI.
- Export to other BI- tools via API on request.

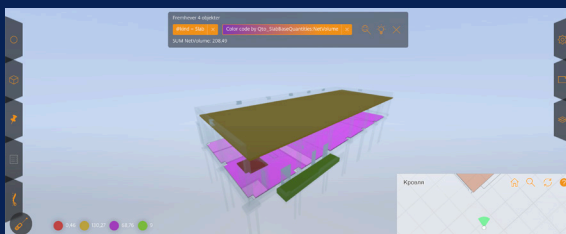
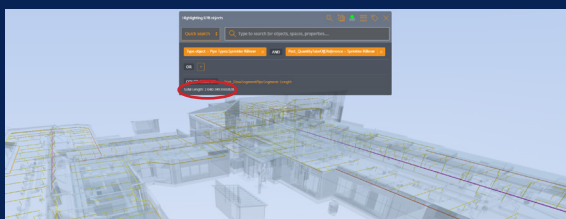

Make the data work for YOU!

All business processes starts with a subset of the federated model. Your ability to efficiently narrow it down to YOUR relevant dataset is key to success.



- All information in your model is made available quick and easy with just a few clicks.
- Results in both 2D and 3D when you need it on all devices.
- Find the location on any object.
- Narrow down the information and geometry relevant to the location of your work.

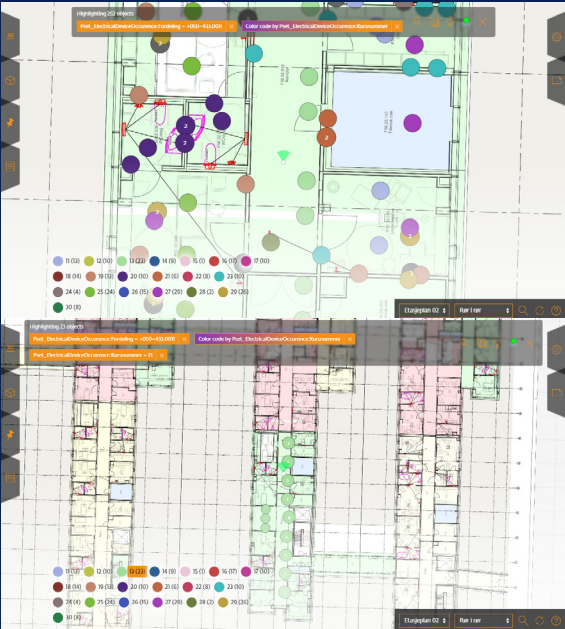

2D- tags

Create your own “Views” with 2D-tags based on the information you need and save it to a “Capture” point.

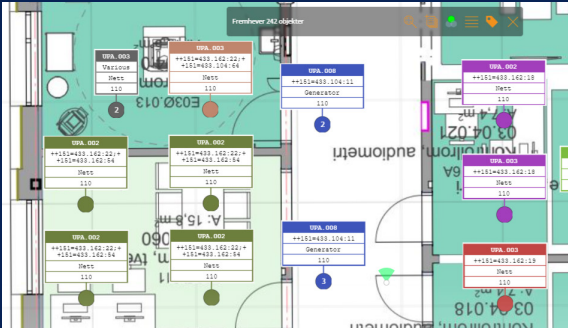

- Share your capture with anyone needed to ensure the correct and relevant information is given.
- The tags can be enriched with any information in the 3D- model.
- The tags scale and rotate with the position and size of your screen to ensure a readable text.

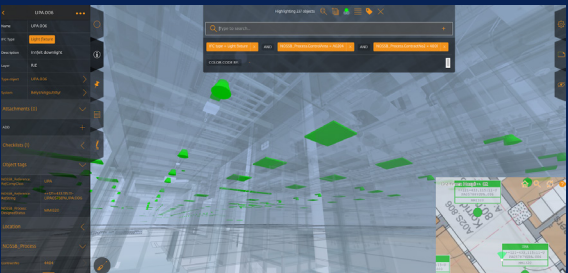
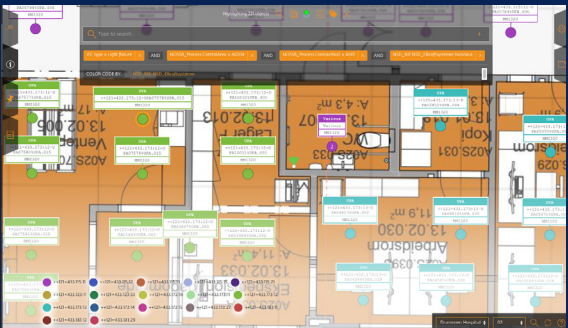

3rd party integration

We believe information should be easily accessible for whoever needs it, when they need it. Our platform is based on open standards, and we support easy integration with 3rd parties.

This enables our customers to take control of their data and use it efficiently on our platform or other preferred software through API integrations.

We know this will support flexibility for our customers to change strategy and choice of software when or if they need it.

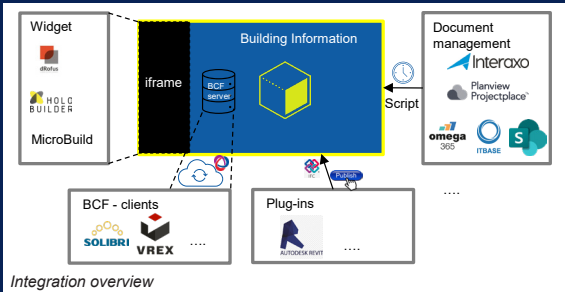

In our widget solution we can integrate 3rd party software directly in our platform and interact with the geometry and information in the IFC models. Currently we support integration with dRofus, Holo Builder and MicroBuild, but we are working with more. We also do integrations on request for our customers.

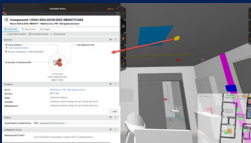

Example: dRofus widget- integration



Example: MicroBuild widget- integration

StreamBIM currently support:

- IFC
- BCF (BIM Collaboration Format, open format for communication with location in x,y,z)
- E57 & Laz (Point cloud formats)
- Open API
- FTP

Manage your project data

The project dashboard gives good overview of all your issues during the project life cycle.

With this overview you have full control of what issues are assigned to whom and from, what due date they have and contract they belong to.

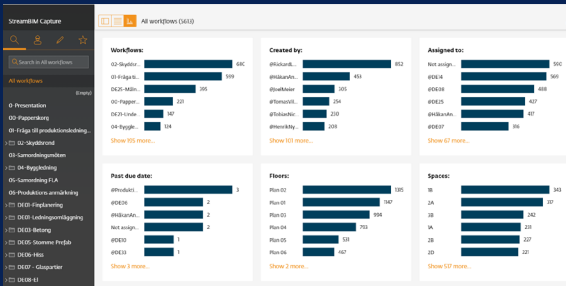

Additionally, you can drill down to see: responsibility, location, what category and including tags they have and status.

Everything can easily be exported to reports in pdf, excel or BCF, and its easy to sync data from multiple projects to enterprise dashboards via API.

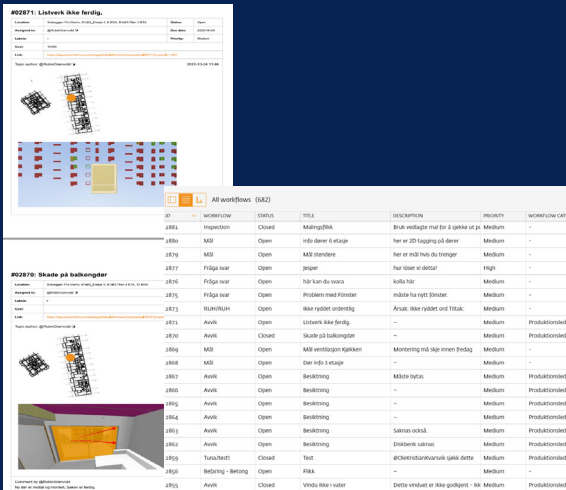

Project diary

Do you wonder what happened in your project on specific dates? Maybe you have issues as a result of weather conditions, or you just want so see what the level of activity is at specific dates.

We can enable that history for you so it's easily accessible if needed.

Days	Mandag 14. juni 2021
2021	WEATHER Moderat regi 16.9°C 7.2 m/s Change location
2022	WEATHER COMMENTS
11.	
12.	Åpen Utløst Løst New workflow232 0 (0) 0 (0) 0 (0)
13.	Åpen Utløst Løst Arbeidsfluter Avvik 0 (0) 0 (0) 0 (0) Legacy 0 (0) 0 (0) 0 (0)
14.	Åpen Utløst Løst @Project 0 (0) 0 (0) 0 (0)
15.	Åpen Utløst Løst Ikk startet Påbegynt Ferdig
16.	Åpen Utløst Løst New checklist 0 (0) 0 (0) 0 (0)
17.	Åpen Utløst Løst Sikkerhet 321 0 (1-15) 0 (0) 0 (0)
18.	Åpen Utløst Løst NewDoorsChecklist 0 (0) 0 (0) 0 (0)
19.	Åpen Utløst Løst Test 0 (0) 0 (0) 0 (0)
20.	WORK FORCE
21.	DELAYS

The project diary gives detailed information of progress and conditions on specific dates.

For example, it gives daily reports on:

- Workflows/issues
- Checklists
- Weather conditions
- Delays
- Etc.

Point clouds

StreamBIM support and stream gigabytes of point- clouds seamlessly on any device. This enables you to compare the designed BIM with actual construction “As built”, measure geometry in the point clouds or between point clouds and BIM.



Features:

- Measure deviations between 3D models and the Laser scans.
- Turn the BIM transparent to see the "As built" Point-clouds inside overlaying geometry.
- Give the Point- cloud a color to better see overlapping geometry.
- Layers you can turn on and of.
- Topics with mix of IFC and point cloud.
- View design models in point cloud of surroundings.
- Supports the file formats: e57 and las.



Takt planning and monitoring

StreamBIM can be used for model-based production planning and progress monitoring with our Takt module. This enables you to plan a “Work package” production schedule based on volumes in your BIM. The volumes is based on location and sequence, where the handover of the “Wagons / Volumes” is accepted or not accepted by the assignees. That way you can track the scheduled production with the current progress.

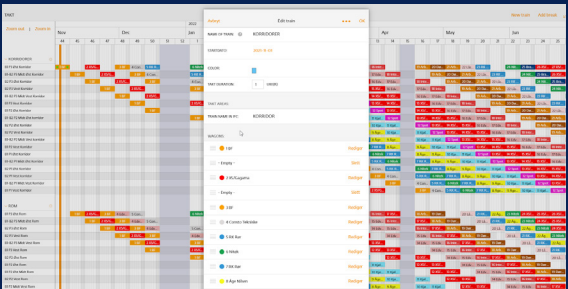

Features:

- Use IFC spaces or zones as takt zones.
- Build trains and wagons with checklists.
- Seamless handover of the “Production zones” with functionality to accept or decline the handover.
- Visualize progress and warnings of delay.
- You can get an overview of the relevant production zones in both 2D and 3D, including their status.

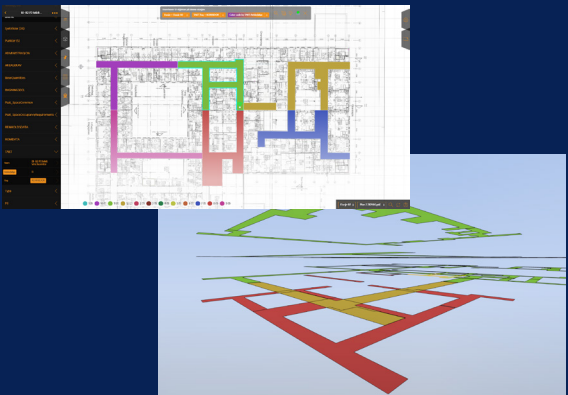

World class implementation



StreamBIM is easy to implement. A good example is the ease of implementing StreamBIM in Takenaka Corporation, our largest enterprise customer.

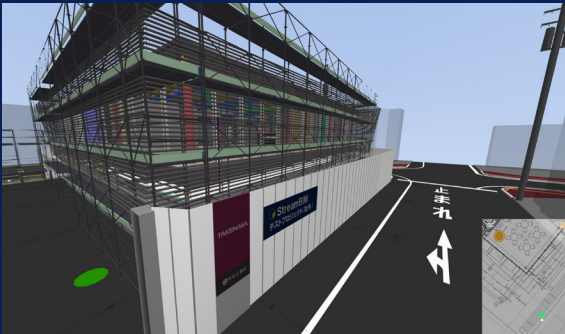

Takenaka Corporation is one of Japan's "big five", they are an international design and construction company with a 400 year history. As of 2020 StreamBIM has had the pleasure of being a central part of their digitalisation project and the new Takenaka Building System.

Due to the pandemic and travel restrictions, Takenaka had to implement StreamBIM with only online assistance from Rendra, but have managed this process impressively with internal resources and a bit of long-distance consultation on best practice from us.

As of late 2022, about 70% of projects are run in StreamBIM - spanning a variety of high-rises, sports-, health care-, hospitality-, educational and public projects in East- and South Asia.

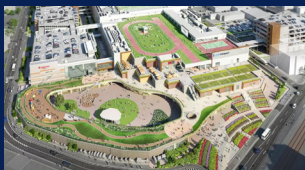

Close the gap

Close the gap between design and production and enable seamless collaboration for your projects with StreamBIM!



BIM data and latest drawings, at the point of production.

- Easy and intuitive user interface.
- Minimize need for drawings.
- From push to pull - extract measurements and supply-chain info you need to install/build.
- Enable real-time collaborative workflows.
- Connects the design and field teams.
- Involve and engage project teams around your models.
- Collaborate from anywhere in your favorite online meeting software.



Our typical customers

We are widely used by all parties in the AEC industry from the start to end.

Our typical clients consist of:

- General contractors
- Public and private building owners
- Sub-contractors (MEP)
- Architects
- Engineering

Trusted by:



Get in touch

If you have any questions about StreamBIM, need help getting started with your project or to schedule a demo. Or if you just want to talk about BIM and digitization in general.



J. Cato Hoel

Chief Marketing Officer & Implementation Strategist
(Sales manager, DACH region)

M: +47 92 85 79 77

E: cato@rendra.io

GET STARTED EVEN TODAY

With a 30 day free trial at
<https://streambim.com/free-trial-basic-english/>

